

FU115F 产品样本

FU115F 系同轴型电极结构全属陶瓷四级管, 采用旁热式长寿命氧化物阴极, 鼠笼型栅极。工作频率可达 300MHZ, 阳极额定耗散功率为 1.8KW。



1 基本特性

1.1 阴极特性

加热方式	间热式
加热电压 (U_f)	3.8V
加热电流 (I_f)	$20.5 \pm 2A$

1.2 静态特性

内放大系数	11
跨导 ($U_a=3kV, U_{g2}=500V, I_a=0.5A$)	55mA/V
阴极与控制栅极间电容	36pF
控制栅极与帘栅极间电容	57pF
帘栅极与阳极间电容	12pF
阴极与阳极间电容	0.015pF
控制栅极与阳极间电容	0.15pF
帘栅极与阴极间电容	1.5pF

2 最大额定值

频率	f	300	MHz
阳极直流电压	U_a	3.1	kV
二栅直流电压	U_{g2}	650	V

一栅直流电压	U_{g1}	-100	V
阳极耗散功率	P_a	1.8	kW

3 典型应用

频率	f	170-230	MHz
阳极直流电压	U_a	2300	V
阳极直流电流（黑电平）		1.1	A
增益		≥ 15	dB
同步顶输出功率		1.2	kW

4 产品外形图

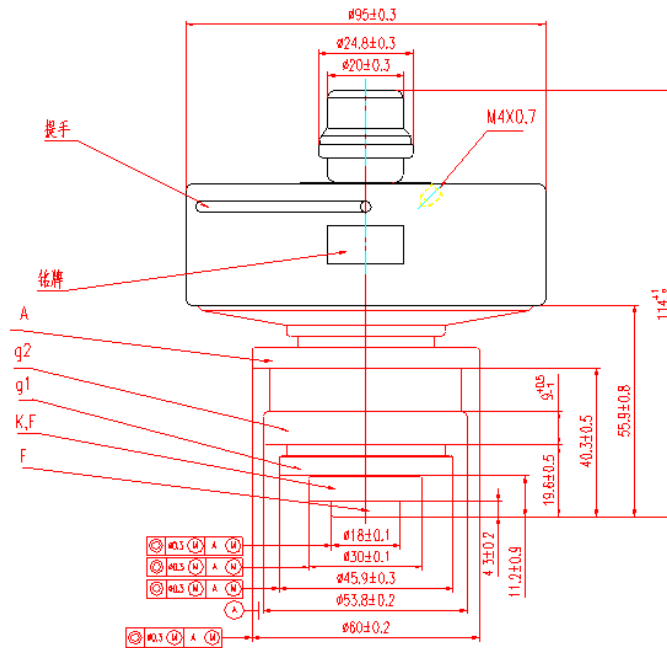

FU115F TETRODE

The FU115F is a forced air-cooled, metal-ceramic tetrode with concentric electrode terminals. The Xuguang's FU115F could be used instead of the RS1072C.

1 General Characteristics

1.1 Cathode Characteristics

Heating	Indirect
Heater Voltage (U_f)	3.8V
Heater Current (I_f)	$20.5 \pm 2A$

1.2 Feature Characteristics

Internal Amplification Factor	11
Transconductance ($U_a=3kV, U_{g2}=500V, I_a=0.5A$)	55mA/V
Interelectrode Capacitances	
Cathode—Control-grid	36pF
Control-grid—Screen-grid	57pF
Screen-grid—Anode	12pF
Cathode—Anode	0.015pF
Control-grid—Anode	0.15pF
Screen-grid—Cathode	1.5pF

3 Maximum Ratings

Frequency	f	300	MHz
Anode DC voltage	U_a	3.1	kV
Screen-grid DC voltage	U_{g2}	650	W
Control-grid DC voltage	U_{g1}	-100	W
Anode Dissipation	P_a	1.8	kW

4 Typical Application

Frequency	f	170-230	MHz
Anode DC Voltage	U_a	2300	V
Anode DC current(black level)		1.1	A
Gain		≥ 15	dB
Peak-sync output power		1.2	kW

4 Product Outline Drawing

