

Q/20258792-X 667 2004 3.6 40.5kV

MAIN TECHNICAL DATA

NFDI D M E D N DI F FE I I F F F

		4500 <sup>500</sup> <sub>0</sub>
		3200 <sup>350</sup> <sub>0</sub>

*movable stem of the VI could only suffering no more than 30N.m twisting force and in order not to damage the metal bellows, the movable stem should be prevent from rotation when assembling. For more requirements please check the Instructions of Usage.*

会 签

Q/20258792-X.2073--2005

灭弧室的外形尺寸，安装尺寸应符合按规定程序审批的图样要求，见图1

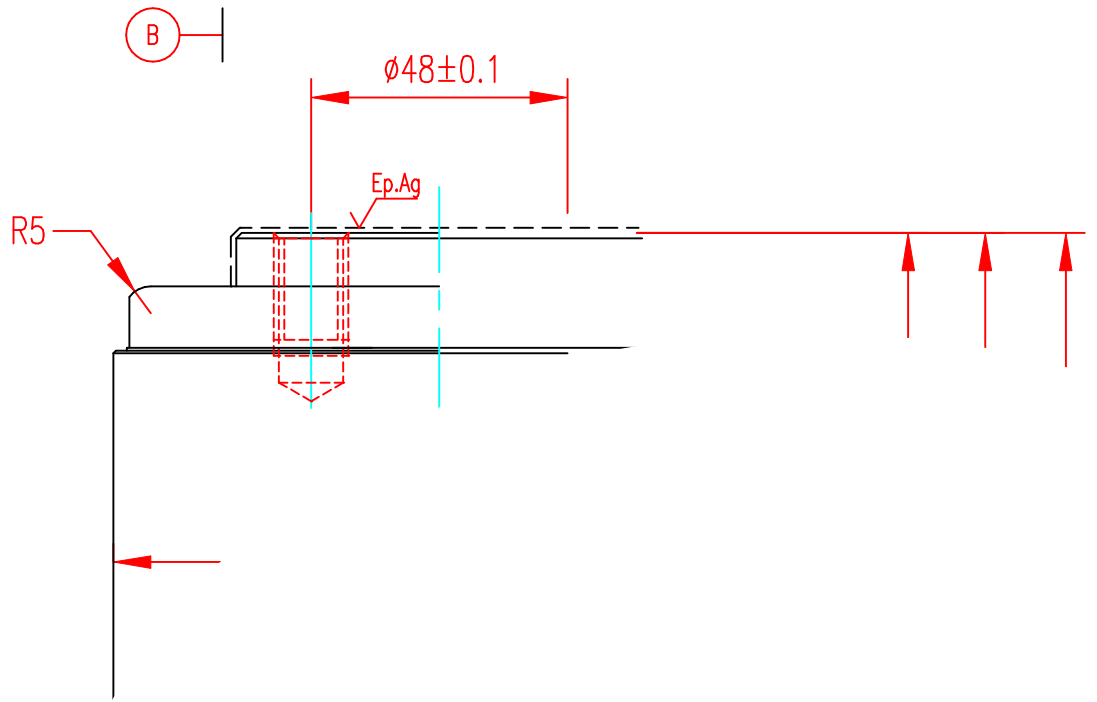

TD-12/3150-40 (2073)

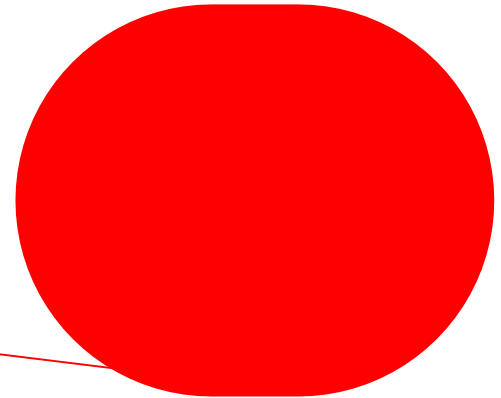

R

铭

name

A—A

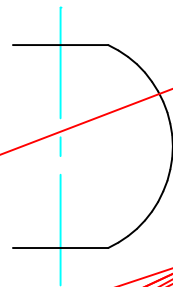

$\phi 36_{-0.1}^0$

责任	签字
制图	
描图	
描校	
旧底图总号	
底图总号	
日期	签字